

**PROPOSED ADDITIONAL & REVISED LAYOUT PLAN FOR COMMERCIAL PLOTTED COLONY FOR AN AREA MEASURING 2.642 ACRES, IN LICENSED COMMERCIAL PLOTTED COLONY MEASURING 11.24375 ACRES (LICENSE NO. - 54 OF 2021 DATED - 20.08.2021 AND 7.79375 ACRES (LICENSE NO. - 131 OF 2022 DATED - 26.08.2022) AND 4.68125 ACRES UNDER CONSIDERATION THERE BY MAKING THE TOTAL SCHEME AREA 26.36075 ACRES, FALLING IN VILLAGE BHATOLA, IN SECTOR - 79, FARIDABAD BEING DEVELOPED BY OMAXE WORLD STREET PVT LTD.**

ARCHITECT SIGN:  ARCHITECT SIGN: 

OWNER SIGN: 

DATE: \_\_\_\_\_ SCALE: 1/50 CHECKED BY: \_\_\_\_\_

DESIGN: \_\_\_\_\_

**LAYOUT PLAN**

**WORLD STREET**

**OMAXE**

**AREA SHEET**

NO.	TYPE	LENGTH	BREADTH	AREA	TOTAL AREA
1	A1 (S.C.)	1.20	1.20	1.44	1.44
2	A2 (S.C.)	1.20	1.20	1.44	2.88
3	A3 (S.C.)	1.20	1.20	1.44	4.32
4	A4 (S.C.)	1.20	1.20	1.44	5.76
5	A5 (S.C.)	1.20	1.20	1.44	7.20
6	A6 (S.C.)	1.20	1.20	1.44	8.64
7	A7 (S.C.)	1.20	1.20	1.44	10.08
8	A8 (S.C.)	1.20	1.20	1.44	11.52
9	A9 (S.C.)	1.20	1.20	1.44	12.96
10	A10 (S.C.)	1.20	1.20	1.44	14.40
11	A11 (S.C.)	1.20	1.20	1.44	15.84
12	A12 (S.C.)	1.20	1.20	1.44	17.28
13	A13 (S.C.)	1.20	1.20	1.44	18.72
14	A14 (S.C.)	1.20	1.20	1.44	20.16
15	A15 (S.C.)	1.20	1.20	1.44	21.60
16	A16 (S.C.)	1.20	1.20	1.44	23.04
17	A17 (S.C.)	1.20	1.20	1.44	24.48
18	A18 (S.C.)	1.20	1.20	1.44	25.92
19	A19 (S.C.)	1.20	1.20	1.44	27.36
20	A20 (S.C.)	1.20	1.20	1.44	28.80
21	A21 (S.C.)	1.20	1.20	1.44	30.24
22	A22 (S.C.)	1.20	1.20	1.44	31.68
23	A23 (S.C.)	1.20	1.20	1.44	33.12
24	A24 (S.C.)	1.20	1.20	1.44	34.56
25	A25 (S.C.)	1.20	1.20	1.44	36.00
26	A26 (S.C.)	1.20	1.20	1.44	37.44
27	A27 (S.C.)	1.20	1.20	1.44	38.88
28	A28 (S.C.)	1.20	1.20	1.44	40.32
29	A29 (S.C.)	1.20	1.20	1.44	41.76
30	A30 (S.C.)	1.20	1.20	1.44	43.20
31	A31 (S.C.)	1.20	1.20	1.44	44.64
32	A32 (S.C.)	1.20	1.20	1.44	46.08
33	A33 (S.C.)	1.20	1.20	1.44	47.52
34	A34 (S.C.)	1.20	1.20	1.44	48.96
35	A35 (S.C.)	1.20	1.20	1.44	50.40
36	A36 (S.C.)	1.20	1.20	1.44	51.84
37	A37 (S.C.)	1.20	1.20	1.44	53.28
38	A38 (S.C.)	1.20	1.20	1.44	54.72
39	A39 (S.C.)	1.20	1.20	1.44	56.16
40	A40 (S.C.)	1.20	1.20	1.44	57.60
41	A41 (S.C.)	1.20	1.20	1.44	59.04
42	A42 (S.C.)	1.20	1.20	1.44	60.48
43	A43 (S.C.)	1.20	1.20	1.44	61.92
44	A44 (S.C.)	1.20	1.20	1.44	63.36
45	A45 (S.C.)	1.20	1.20	1.44	64.80
46	A46 (S.C.)	1.20	1.20	1.44	66.24
47	A47 (S.C.)	1.20	1.20	1.44	67.68
48	A48 (S.C.)	1.20	1.20	1.44	69.12
49	A49 (S.C.)	1.20	1.20	1.44	70.56
50	A50 (S.C.)	1.20	1.20	1.44	72.00
51	A51 (S.C.)	1.20	1.20	1.44	73.44
52	A52 (S.C.)	1.20	1.20	1.44	74.88
53	A53 (S.C.)	1.20	1.20	1.44	76.32
54	A54 (S.C.)	1.20	1.20	1.44	77.76
55	A55 (S.C.)	1.20	1.20	1.44	79.20
56	A56 (S.C.)	1.20	1.20	1.44	80.64
57	A57 (S.C.)	1.20	1.20	1.44	82.08
58	A58 (S.C.)	1.20	1.20	1.44	83.52
59	A59 (S.C.)	1.20	1.20	1.44	84.96
60	A60 (S.C.)	1.20	1.20	1.44	86.40
61	A61 (S.C.)	1.20	1.20	1.44	87.84
62	A62 (S.C.)	1.20	1.20	1.44	89.28
63	A63 (S.C.)	1.20	1.20	1.44	90.72
64	A64 (S.C.)	1.20	1.20	1.44	92.16
65	A65 (S.C.)	1.20	1.20	1.44	93.60
66	A66 (S.C.)	1.20	1.20	1.44	95.04
67	A67 (S.C.)	1.20	1.20	1.44	96.48
68	A68 (S.C.)	1.20	1.20	1.44	97.92
69	A69 (S.C.)	1.20	1.20	1.44	99.36
70	A70 (S.C.)	1.20	1.20	1.44	100.80
71	A71 (S.C.)	1.20	1.20	1.44	102.24
72	A72 (S.C.)	1.20	1.20	1.44	103.68
73	A73 (S.C.)	1.20	1.20	1.44	105.12
74	A74 (S.C.)	1.20	1.20	1.44	106.56
75	A75 (S.C.)	1.20	1.20	1.44	108.00
76	A76 (S.C.)	1.20	1.20	1.44	109.44
77	A77 (S.C.)	1.20	1.20	1.44	110.88
78	A78 (S.C.)	1.20	1.20	1.44	112.32
79	A79 (S.C.)	1.20	1.20	1.44	113.76
80	A80 (S.C.)	1.20	1.20	1.44	115.20
81	A81 (S.C.)	1.20	1.20	1.44	116.64
82	A82 (S.C.)	1.20	1.20	1.44	118.08
83	A83 (S.C.)	1.20	1.20	1.44	119.52
84	A84 (S.C.)	1.20	1.20	1.44	120.96
85	A85 (S.C.)	1.20	1.20	1.44	122.40
86	A86 (S.C.)	1.20	1.20	1.44	123.84
87	A87 (S.C.)	1.20	1.20	1.44	125.28
88	A88 (S.C.)	1.20	1.20	1.44	126.72
89	A89 (S.C.)	1.20	1.20	1.44	128.16
90	A90 (S.C.)	1.20	1.20	1.44	129.60
91	A91 (S.C.)	1.20	1.20	1.44	131.04
92	A92 (S.C.)	1.20	1.20	1.44	132.48
93	A93 (S.C.)	1.20	1.20	1.44	133.92
94	A94 (S.C.)	1.20	1.20	1.44	135.36
95	A95 (S.C.)	1.20	1.20	1.44	136.80
96	A96 (S.C.)	1.20	1.20	1.44	138.24
97	A97 (S.C.)	1.20	1.20	1.44	139.68
98	A98 (S.C.)	1.20	1.20	1.44	141.12
99	A99 (S.C.)	1.20	1.20	1.44	142.56
100	A100 (S.C.)	1.20	1.20	1.44	144.00

**LICENSE GRANTED AREA = 11.24375 ACRES (LICENSE NO. 54 OF 2021 DATED- 20.08.2021)**

**ADDITIONAL LICENSE GRANTED AREA = 7.79375 ACRES (LICENSE NO. 131 OF 2022 DATED- 26.08.2022)**

**ADDITIONAL LAND AREA = 4.68125 ACRES**

**ADDITIONAL LAND AREA = 2.642 ACRES**

**REVISED AREA = 1762.388 SQ. MT. OR = 4.045 ACRES**

**TYPE TOTAL**

SCO 350

BOOTH 71

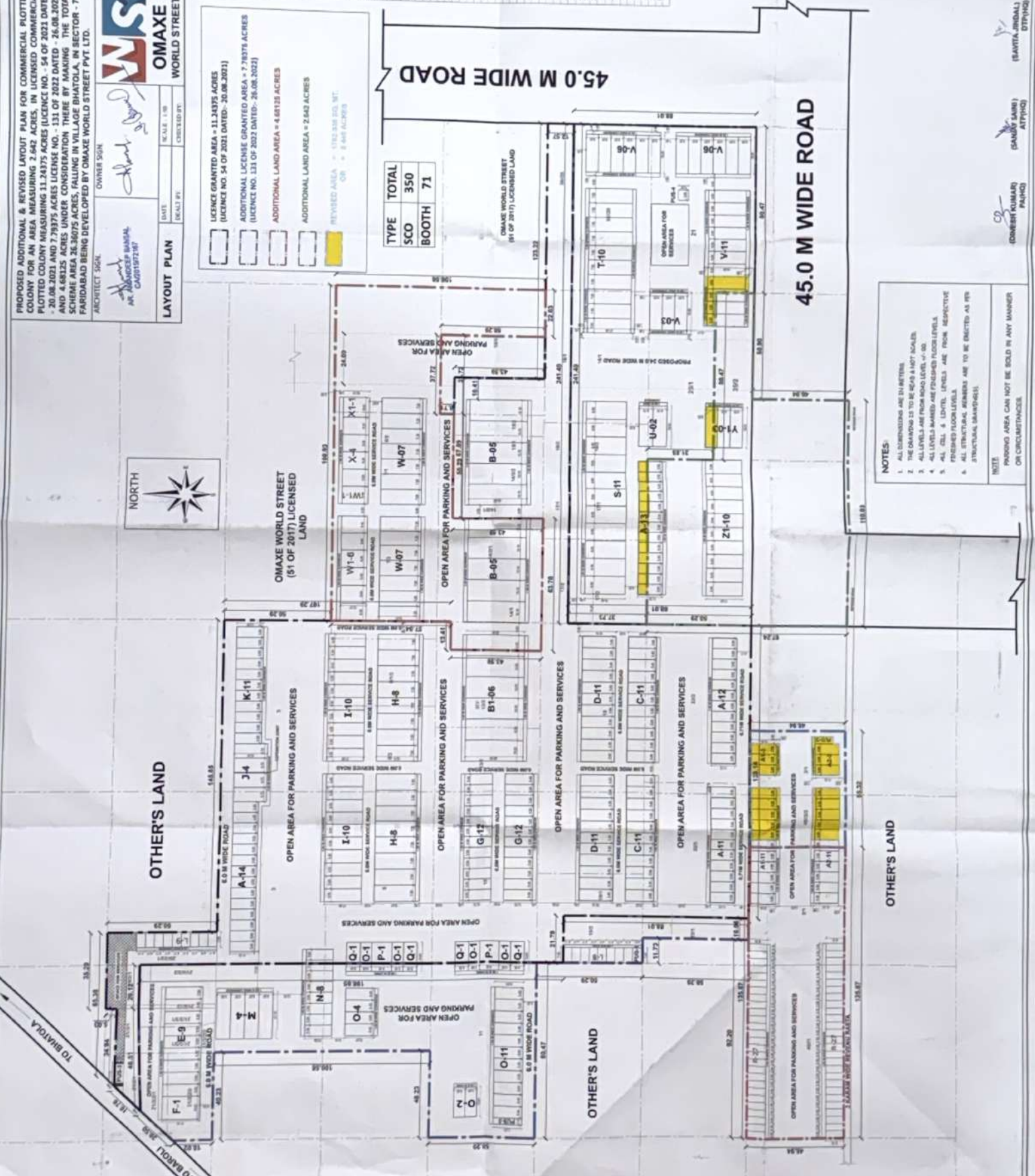

- NOTES:**
1. ALL DIMENSIONS ARE IN METERS.
  2. THE GRADINGS IS TO BE AS PER 1:100 SCALE.
  3. ALL LEVELS ARE FROM ROAD LEVEL (LEVEL 0.0).
  4. ALL LEVELS MARKED ARE FROM FLOOR LEVEL.
  5. ALL GULLY & DRAIN LEVELS ARE FROM RESPECTIVE FINISHED FLOOR LEVEL.
  6. ALL STRUCTURAL, SANITARY ARE TO BE EXECUTED AS PER STRUCTURAL DRAWINGS.
- NOTE:** PAVED AREA CAN NOT BE SOLD IN ANY MANNER OR ENCROACHMENTS

Map to be prepared and submitted to the concerned authorities for approval.

Scale: 1:500 (As per 1:500 Scale)

- (ARVIND KUMAR) (ARTY NIGTAL) (AR)
- (LITENDRA SHARMA) (CTP) (HR)
- (SUDHAKAR SHARMA) (STRATEGY) (HQ)
- (RAVITA JINDAL) (DTP) (HQ)
- (SANGIT SAHNI) (ATYP) (HQ)
- (DHIRESH KUMAR) (PA) (HQ)